

Welcome to the East Area Planning Committee

- This planning committee meeting is held in public but it is not a public meeting.
- There will be an opportunity for the public to address the committee on each application.
- If you wish to speak for or against a planning application, you need to have either requested it in advance, or hand in one of the available speaker forms, or speak to the clerk.
- Information on meeting protocol and conduct at the committee is set out in the Code of Practice.
- This is in the committee agenda just before the first planning application report.

Site Location Plan

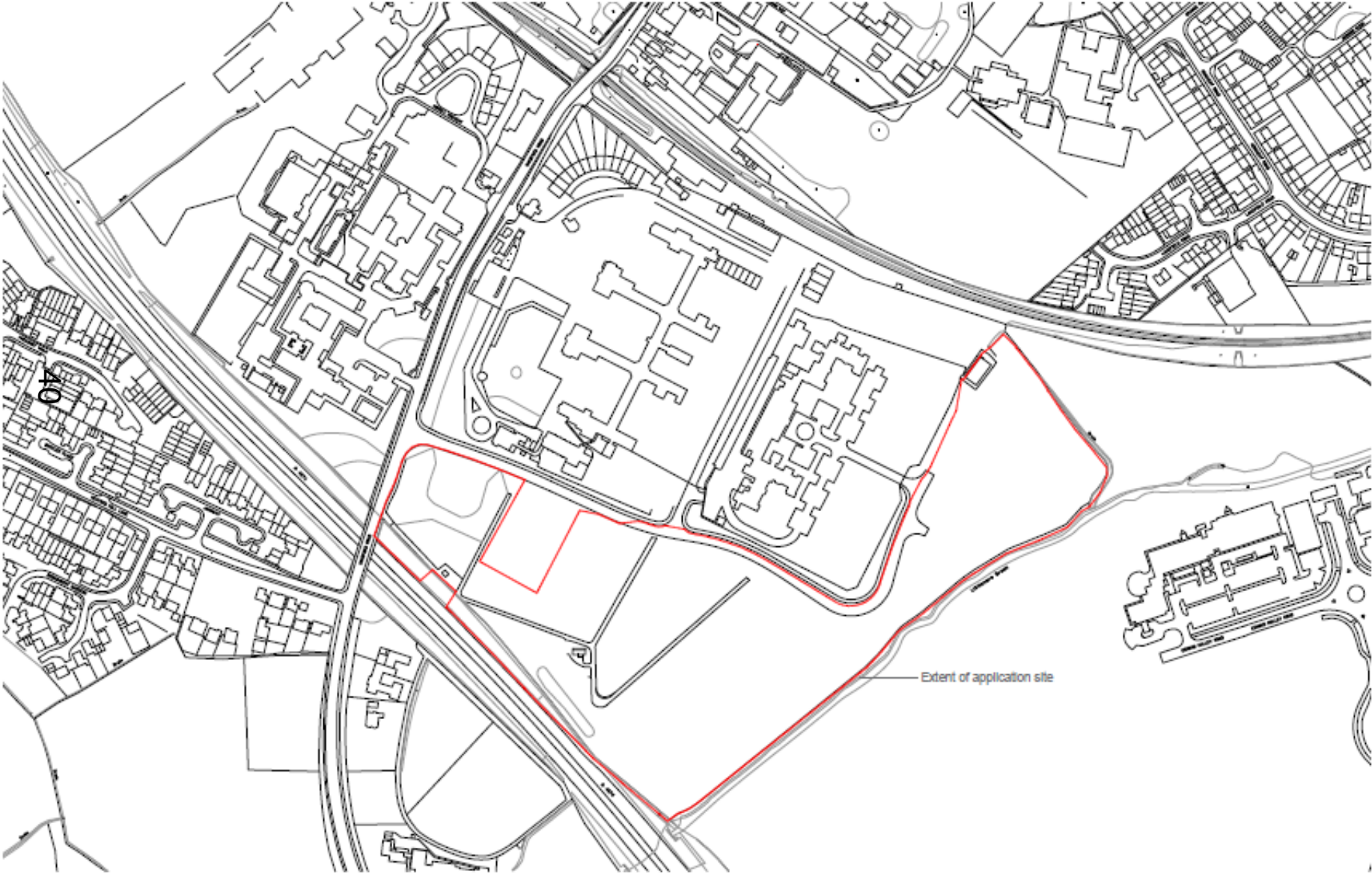



Armstrong Road / Sandford Road Junction



42

View of north-western section of site alongside nursery



43

View of north-western section of site alongside nursery



44

View from middle section looking towards A4074



45

View of middle section of site looking towards Science Park



46

View from north-eastern edge of site looking westwards



47

View from north-eastern edge of site looking towards SAE Institute



48

View from of north-eastern part of the site looking towards Science Park



49

View of Armstrong Road from middle section of site looking towards Sandford Road



50

View of bottom end of Armstrong Road



Notional line showing
extents of burial ground

St George's Manor

Sandford Road

Amersong Road

Copse

51

A4074

Principle
public space

Potential future link to
Oxford Science Park

Littlemore Brook

Oxford Science Park

-  Terraced Housing
-  Apartments
-  Parking
-  Home Zone
-  Private Garden
-  Play Area
-  Wildflower Meadow
-  Crossing Points

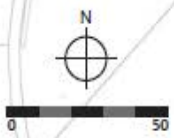

Illustrative Masterplan Littlemore Park

Based upon Topographical Survey carried out for CAPITA by D & H Surveys, November 2013.

Littlemore Park Outline Planning Application
CS_069066
September 2014

CAPITA
Capita, St David's House
Palace Close, St Mellors
Cardiff
CF3 0LD

Landscape Plan / Open Space



Access and Pedestrian / Cycle links





- Notional line flood zone
- Planning Application Boundary
- For Approval**
 - Residential up to 11.5 meters / 2 - 3 storey
 - Residential up to 13 meters / 4 - 5 storey
 - Residential up to 16 meters / 5 storey
- Existing Buildings**
 - 1 storey
 - 2 storey
 - 3 - 4 storey
- Note:
All building heights are based on roof ridgeline and exclude structures such as chimneys or flues

Building Scale

Illustrative Sections

55



This page is intentionally left blank